

CRANE HOOK catalog



Introduction

Crane hook is a device for grabbing and lifting loads by means of a device such as a hoist or crane.

Hook structure

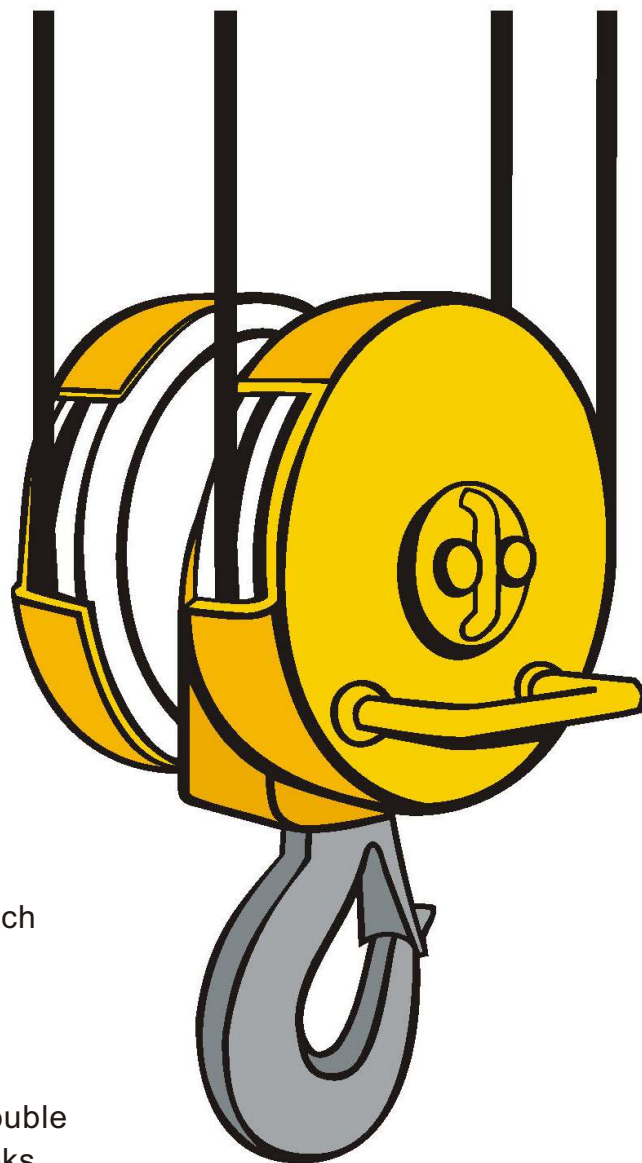
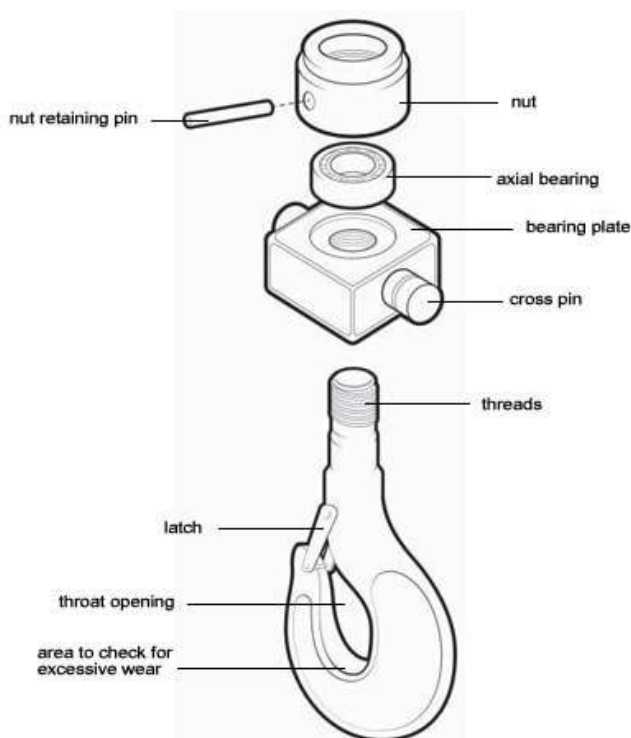

Note: Hook is usually equipped with a safety latch to prevent the disengagement of the lifting wire rope sling, chain or rope to which the load is attached.

Hooks can be classified into single hook and double hooks according to the appearance; forged hooks and strapped hooks according to production method.

Which hook to choose?

Single hook for crane

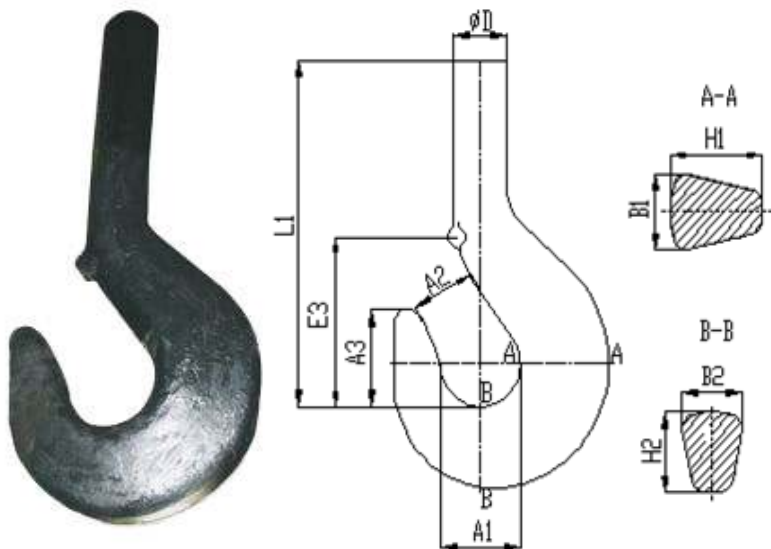

Capacity of Single Hook:
5t/6t/10t/12t/16t/20t/25t/32t/40t/50t/63t/80t/100t/125t/160t/200t/250t

Single hook is easy to produce and use, but its load carrying is not good, so most of time, it is only used at the low capacity working site (less than 80T).

| 钩号 | A1 | A2 | A3 | φh | E3 | L1 | B1 | B2 | H1 | H2 | 重量 (kg) |
|------|-----|-----|-----|-----|-----|------|-----|-----|-----|-----|-----------|
| 5# | 80 | 63 | 90 | 53 | 165 | 318 | 71 | 60 | 90 | 75 | 13 |
| 6# | 90 | 71 | 101 | 60 | 185 | 380 | 80 | 67 | 100 | 85 | 18 |
| 10# | 112 | 90 | 127 | 75 | 221 | 460 | 100 | 85 | 125 | 106 | 40 |
| 12# | 125 | 100 | 143 | 85 | 252 | 510 | 112 | 95 | 140 | 118 | 48 |
| 16# | 140 | 112 | 160 | 95 | 280 | 595 | 125 | 106 | 160 | 132 | 80 |
| 20# | 160 | 125 | 180 | 106 | 330 | 665 | 140 | 118 | 180 | 150 | 115 |
| 25# | 180 | 140 | 202 | 118 | 360 | 724 | 160 | 132 | 200 | 170 | 140 |
| 32# | 200 | 160 | 225 | 132 | 400 | 810 | 180 | 150 | 224 | 190 | 220 |
| 40# | 224 | 180 | 252 | 150 | 447 | 905 | 200 | 170 | 250 | 212 | 310 |
| 50# | 250 | 200 | 285 | 170 | 485 | 990 | 224 | 190 | 280 | 236 | 430 |
| 63# | 280 | 224 | 320 | 190 | 550 | 1120 | 250 | 212 | 315 | 265 | 600 |
| 80# | 315 | 250 | 358 | 212 | 598 | 1270 | 280 | 236 | 355 | 300 | 860 |
| 100# | 355 | 280 | 402 | 236 | 688 | 1415 | 315 | 265 | 400 | 335 | 1220 |
| 125# | 400 | 315 | 450 | 265 | 750 | 1590 | 355 | 300 | 450 | 375 | 1740 |
| 160# | 450 | 355 | 505 | 300 | 825 | 1790 | 400 | 335 | 500 | 425 | 2480 |
| 200# | 500 | 400 | 565 | 335 | 900 | 2048 | 450 | 375 | 560 | 475 | 3420 |
| 250# | 560 | 450 | 635 | 375 | 980 | 2305 | 500 | 425 | 630 | 530 | 4800 |

Double hook for crane

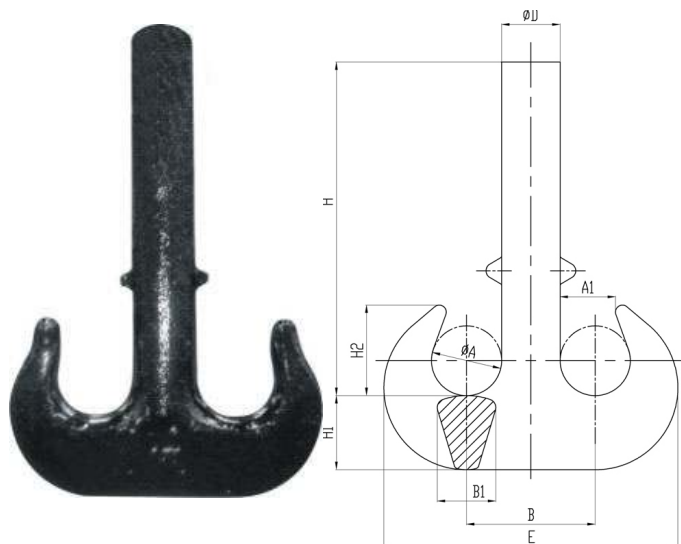

When the capacity is large, double hook with symmetrical load carrying will be used.

Capacity of double hook:
10t/12t/16t/20t/25t/32t/40t/50t/63t/80t/100t/125t/160t/200t/250t.

| 钩号 | φ D | φ A | A1 | H | H1 | H2 | B1 | B | E | 重量 (kg) |
|------|-----|-----|-----|------|-----|-----|-----|-----|------|-----------|
| 10# | 75 | 90 | 71 | 505 | 95 | 116 | 75 | 165 | 377 | 36.3 |
| 12# | 85 | 100 | 80 | 594 | 106 | 130 | 85 | 185 | 421 | 50.5 |
| 16# | 95 | 112 | 90 | 642 | 118 | 146 | 95 | 207 | 471 | 71.1 |
| 20# | 106 | 125 | 100 | 698 | 132 | 163 | 106 | 231 | 531 | 99.5 |
| 25# | 118 | 140 | 112 | 750 | 150 | 182 | 118 | 258 | 598 | 138 |
| 32# | 132 | 160 | 125 | 830 | 170 | 205 | 132 | 292 | 672 | 197 |
| 40# | 150 | 180 | 140 | 930 | 190 | 230 | 150 | 330 | 754 | 286 |
| 50# | 170 | 200 | 160 | 998 | 212 | 260 | 170 | 370 | 842 | 394 |
| 63# | 190 | 224 | 180 | 1120 | 236 | 292 | 190 | 414 | 944 | 547 |
| 80# | 212 | 250 | 200 | 1250 | 265 | 325 | 212 | 462 | 1062 | 759 |
| 100# | 238 | 280 | 224 | 1400 | 300 | 364 | 238 | 518 | 1186 | 1060 |
| 125# | 265 | 315 | 250 | 1600 | 335 | 408 | 265 | 580 | 1330 | 1491 |
| 160# | 300 | 355 | 280 | 1800 | 375 | 458 | 300 | 655 | 1505 | 2115 |
| 200# | 335 | 400 | 315 | 2000 | 425 | 515 | 335 | 735 | 1685 | 3015 |
| 250# | 375 | 450 | 355 | 2250 | 475 | 580 | 375 | 825 | 1885 | 4268 |

Strapped hooks



Strapped hooks is riveting by several cutting forming steel plate, respective steel plate has its safety feature is better, But its self-weight is large, mostly be used in large capacity or lifted molten steel cranes.

General Drawing or Sketch or Draft Drawing

| crane hook parameter | | | | | | | | | | | | | | | |
|----------------------|----------|------|------|------|------|-----|-----|-----|-----|-----|------|-----|-----------------|-------------|------------|
| Specification | Size(mm) | | | | | | | | | | | | Steel wire rope | | Weight(kg) |
| | A | B | H | E | G | L | L1 | L2 | C | U | ΦD1 | ΦD | Dia (mm) | Branch (pc) | |
| 3.2T | 637 | 338 | 380 | 245 | 130 | 222 | / | / | 50 | 65 | / | 250 | 11~14 | 4 | 80 |
| 5T | 846 | 382 | 480 | 320 | 236 | / | 184 | / | 65 | 85 | / | 350 | 11~14 | 4 | 100 |
| 10T | 1110 | 370 | 460 | 420 | 240 | / | 93 | / | 90 | 120 | 400 | 250 | 11~14 | 6 | 200 |
| 16T | 1277 | 512 | 660 | 440 | 285 | / | 179 | / | 115 | 150 | 500 | 300 | 14~20 | 6 | 330 |
| 20T | 1440 | 516 | 660 | 520 | 335 | 134 | 94 | / | 130 | 170 | / | 500 | 16~20 | 8 | 460 |
| 32T | 1730 | 596 | 780 | 610 | 420 | 154 | 108 | / | 160 | 210 | / | 610 | 18~22 | 8 | 845 |
| 50T | 2085 | 724 | 880 | 720 | 510 | 161 | 108 | / | 205 | 270 | 710 | 610 | 20~22 | 10 | 1500 |
| 75T | 2335 | 970 | 1012 | 930 | 600 | 185 | 135 | / | 250 | 320 | 800 | 500 | 26~32 | 10 | 1500 |
| 100T | 3130 | 1360 | 1162 | 1100 | 955 | 350 | 131 | 200 | 270 | 355 | 1000 | 800 | 28~34 | 12 | 4200 |
| 200T | 3548 | 1617 | 1090 | 1185 | 1298 | 159 | 264 | / | / | 340 | 1100 | 900 | 30~38 | 12 | 9100 |

Schematic diagram of hook unit structure

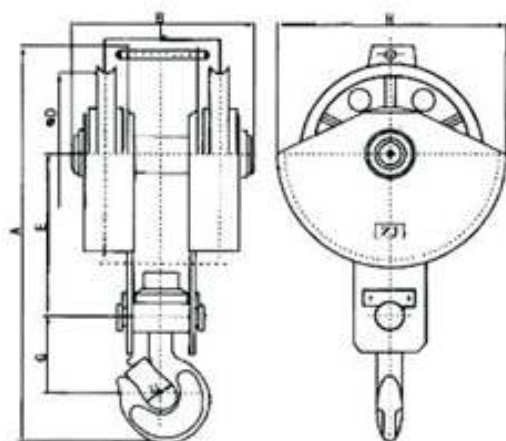

3.2T吊钩组
(3.2T Hook unit)

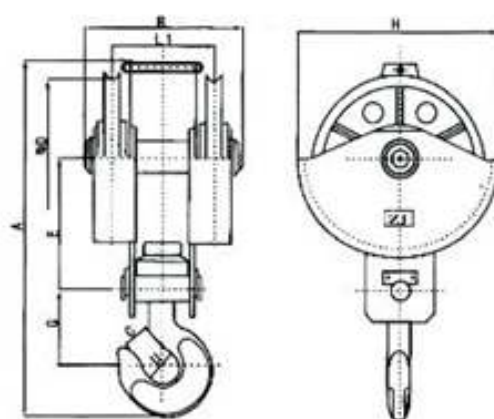

5T吊钩组
(5T Hook unit)

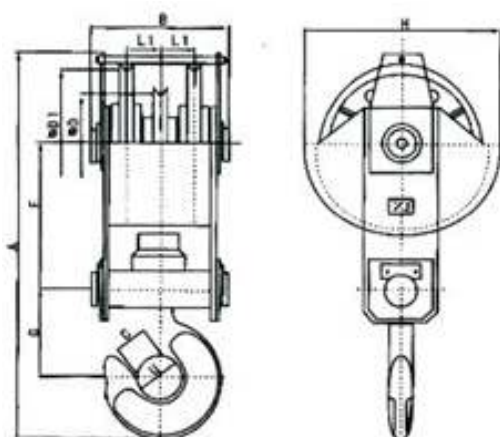

10T吊钩组
(10T Hook unit)

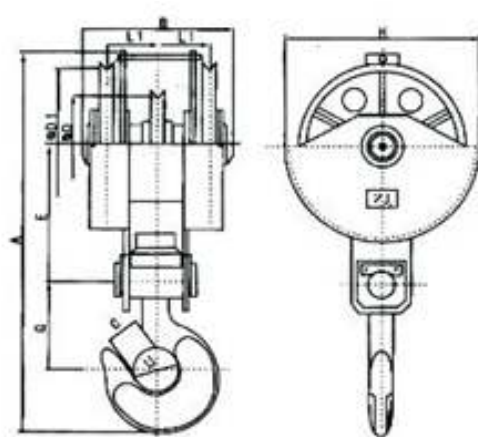

16T吊钩组
(16T Hook unit)

CRANE HOOK CATALOG

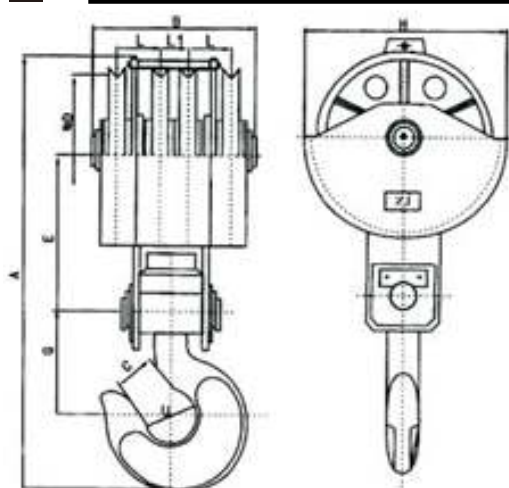

20T吊钩组
(20T Hook unit)

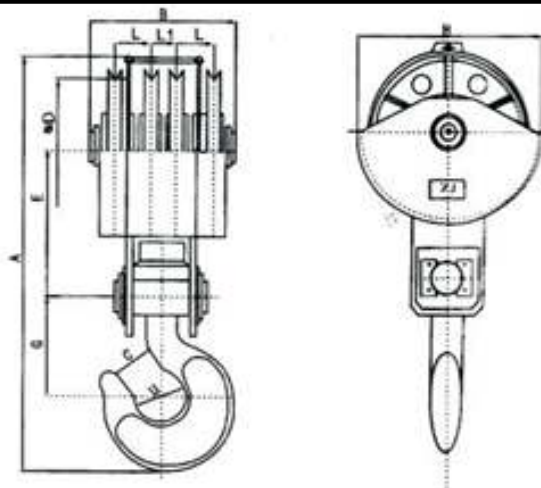

32T吊钩组
(32T Hook unit)

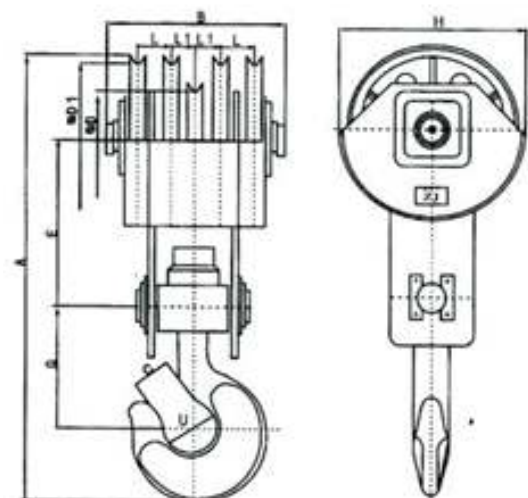

50T吊钩组
(50T Hook unit)

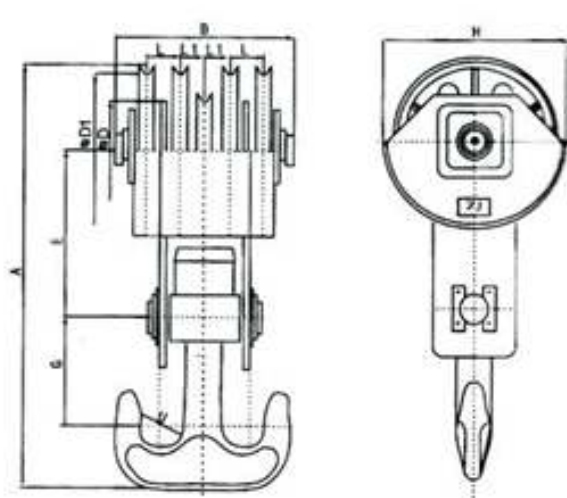

75T吊钩组
(75T Hook unit)

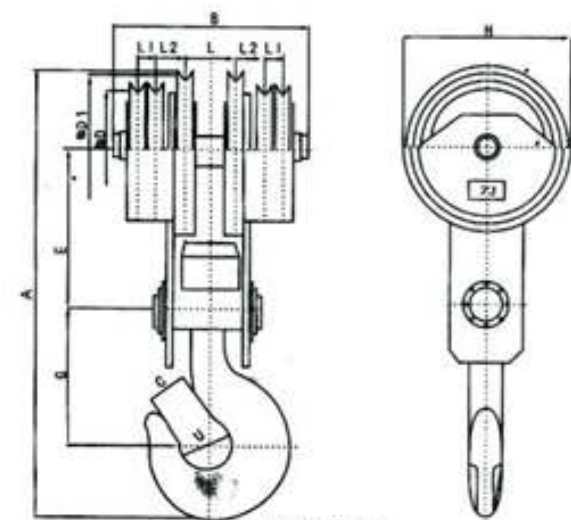

100T吊钩组
(100T Hook unit)

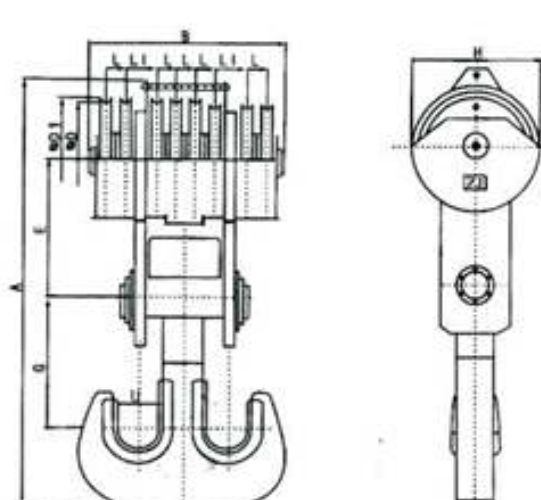

200T吊钩组
(200T Hook unit)

Manufacturing workshop and equipments of hooks

Five strength grades M, P, S, T, V, are classified in accordance with mechanical property. Forging hook and strap type hook are manufactured according to method of manufacturing.



Hook Materials:

M grade with DG20, or DG20Mn

P grade with DG20Mn

S grade with DG34CrMo

T grade below 40t with DG34CrMo, more than 40t with DG34CrNiMo or DG30Cr2Ni2Mo

V grade below 40t with DG34CrNiMo or DG30Cr2Ni2Mo, more than 40t with DG30Cr2Ni2Mo.

Different Strength Grade & Mechanism Working Grade & Hook Lifting Capacity

| Strength Grade | Mechanism Working Grade (According to Gb3811) | | | | | | | | | | Strength Grade |
|----------------|-----------------------------------------------|-----|-----|------|------|-----|------|------|------|------|----------------|
| M | - | - | - | - | M3 | M4 | M5 | M6 | M7 | M8 | M |
| P | - | - | - | M3 | M4 | M5 | M6 | M7 | M8 | - | P |
| (S) | - | - | M3 | M4 | M5 | M6 | M7 | M8 | - | - | (S) |
| T | - | M3 | M4 | M5 | M6 | M7 | M8 | - | - | - | T |
| (V) | M3 | M4 | M5 | M6 | M7 | M8 | - | - | - | - | (V) |
| Hook No. | Lifting Capacity (t) | | | | | | | | | | Hook No. |
| 5 | 25 | 20 | 16 | 12.5 | 10 | 8 | 6.3 | 5 | 4 | 3.2 | 5 |
| 6 | 32 | 25 | 20 | 16 | 12.5 | 10 | 8 | 6.3 | 5 | 4 | 6 |
| 10 | 50 | 40 | 32 | 25 | 20 | 16 | 12.5 | 10 | 8 | 6.3 | 10 |
| 12 | 63 | 50 | 40 | 32 | 25 | 20 | 16 | 12.5 | 10 | 8 | 12 |
| 16 | 80 | 63 | 50 | 40 | 32 | 25 | 20 | 16 | 12.5 | 10 | 16 |
| 20 | 100 | 80 | 63 | 50 | 40 | 32 | 25 | 20 | 16 | 12.5 | 20 |
| 25 | 125 | 100 | 80 | 63 | 50 | 40 | 32 | 25 | 20 | 16 | 25 |
| 32 | 160 | 125 | 100 | 80 | 63 | 50 | 40 | 32 | 25 | 20 | 32 |
| 40 | 200 | 160 | 125 | 100 | 80 | 63 | 50 | 40 | 32 | 25 | 40 |
| 50 | 250 | 200 | 160 | 125 | 100 | 80 | 63 | 50 | 40 | 32 | 50 |
| 63 | 320 | 250 | 200 | 160 | 125 | 100 | 80 | 63 | 50 | 40 | 63 |
| 80 | 400 | 320 | 250 | 200 | 160 | 125 | 100 | 80 | 63 | 50 | 80 |
| 100 | 500 | 400 | 320 | 250 | 200 | 160 | 125 | 100 | 80 | 63 | 100 |
| 125 | - | 500 | 400 | 320 | 250 | 200 | 160 | 125 | 100 | 80 | 125 |
| 150 | - | - | 500 | 400 | 320 | 250 | 200 | 160 | 125 | 100 | 150 |
| 200 | - | - | - | 500 | 400 | 320 | 250 | 200 | 160 | 125 | 200 |
| 250 | - | - | - | - | 500 | 400 | 320 | 250 | 200 | 160 | 250 |

Note: If working grade below M3, pls take it as M3 into consideration.

| Hook No. | Shank Diameter Φ D (mm) | Strength Grade | | | | |
|----------|----------------------------|----------------------|--------|----------|----------------------------------|----------------------------------|
| | | M | P | (S) | T | (V) |
| 5 | 53 | DG20 Or DG20Mn | DG20Mn | DG34CrMo | DG34CrMo | DG34CrNiMo Or DG30Cr2Ni2Mo |
| 6 | 60 | | | | | |
| 10 | 75 | | | | | |
| 12 | 85 | | | | | |
| 16 | 95 | | | | | |
| 20 | 106 | | | | | |
| 25 | 118 | | | | | |
| 32 | 132 | | | | | |
| 40 | 150 | | | | | |
| 50 | 170 | | | | DG34CrNiMo Or DG30Cr2Ni2Mo | DG30Cr2Ni2Mo |
| 63 | 190 | | | | | |
| 80 | 212 | | | | | |
| 100 | 236 | | | | | |
| 125 | 265 | | | | | |
| 160 | 300 | | | | | |
| 200 | 335 | | | | | |
| 250 | 375 | | | | | |

Processing machine



5t linkage manipulator



5t manipulator for material handling



60t manipulator



annealing furnace



C61200 horizontal lathe



CNC



YJM4232 gantry machining center



Table saw



TQ32-6000 Hydraulic Press



10000t Hydraulic Press



2000t tensile testing machine

Hook block



Single hook



Double hook



Laminated hook



Single hook



Electric rotary hook



Ex-proof hook

Our hook warehouse

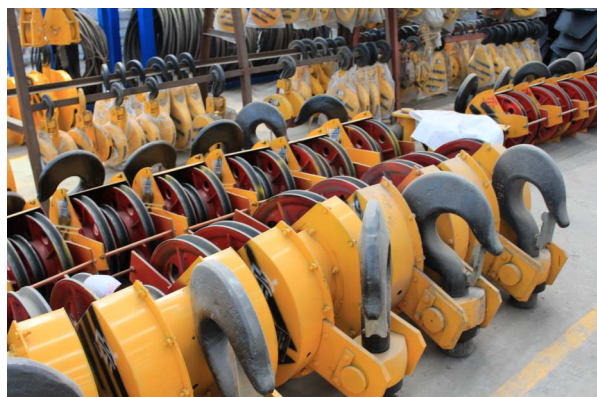

Hook Test

In order to ensure safety, hook must pass the test, when found to be one of the following conditions, the hook must be set to be scrapped, welding repair is not allowed.

Rack appeared.

The dangerous section of wear is made according to GB10051.2 hook, no more than 5% of the original height; According to standard line continue to use the hook, should be more than 10% of the original size.

Openness is increased by 15% of the originals.

Reverse deformation more than 10 degrees.

Dangerous section or a hook neck produces plastic deformation.

Late hook liner wear is up to 50% of the original size, the core set of should be scrap.

Board hook core shaft wear is up to 5% of the original size, the spindle should be scrap.



Package and delivery of hooks



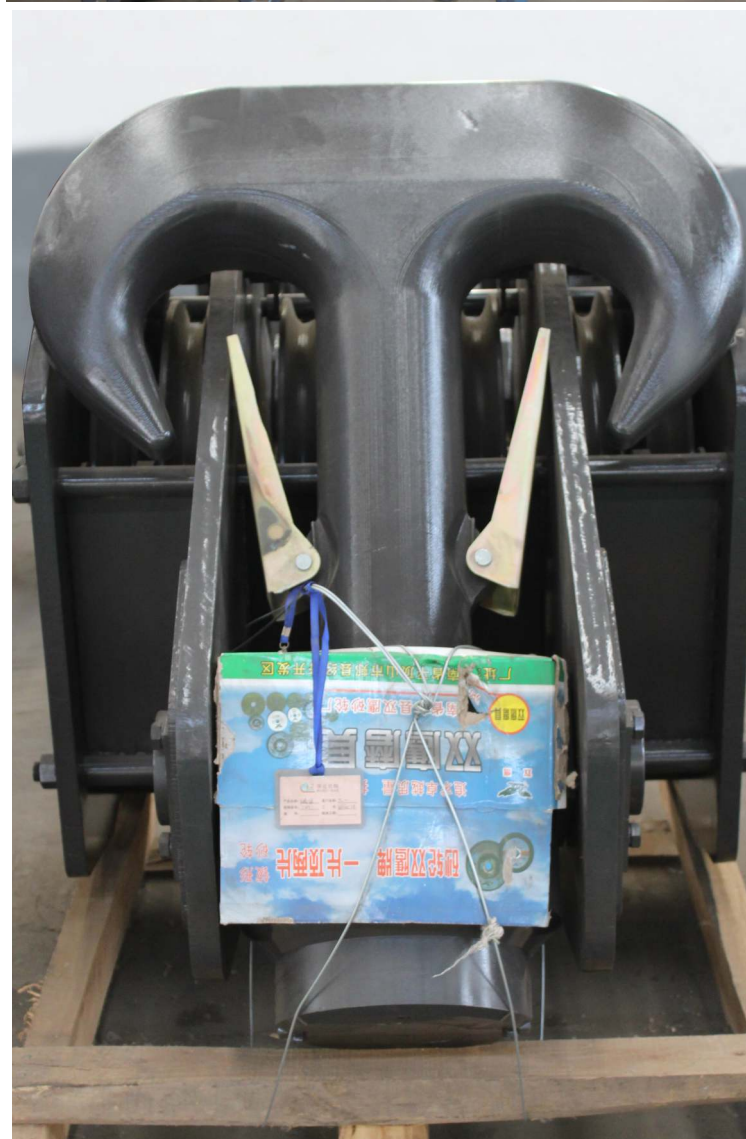



keeping industry on the move

Email: info@dgcrane.com Tel: +86-373-3876188

Fax: +86-373-3876088 M.p: +86-18638327972 Web: www.dgcrane.com

ADD: Changnao Industrial District,Xinxiang city,Henan province,China