

# CRANE HOOK catalog



## Introduction

Crane hook is a device for grabbing and lifting loads by means of a device such as a hoist or crane.

### Hook structure

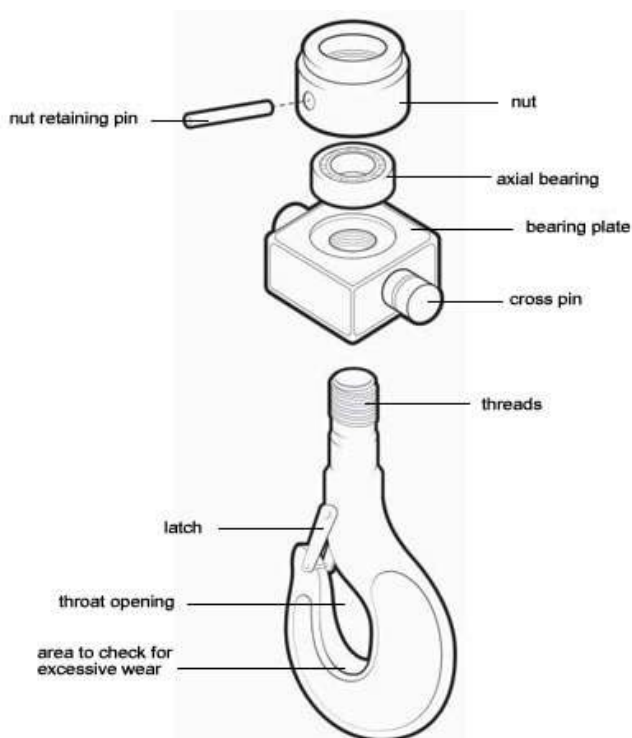

Note: Hook is usually equipped with a safety latch to prevent the disengagement of the lifting wire rope sling, chain or rope to which the load is attached.

Hooks can be classified into single hook and double hooks according to the appearance; forged hooks and strapped hooks according to production method.

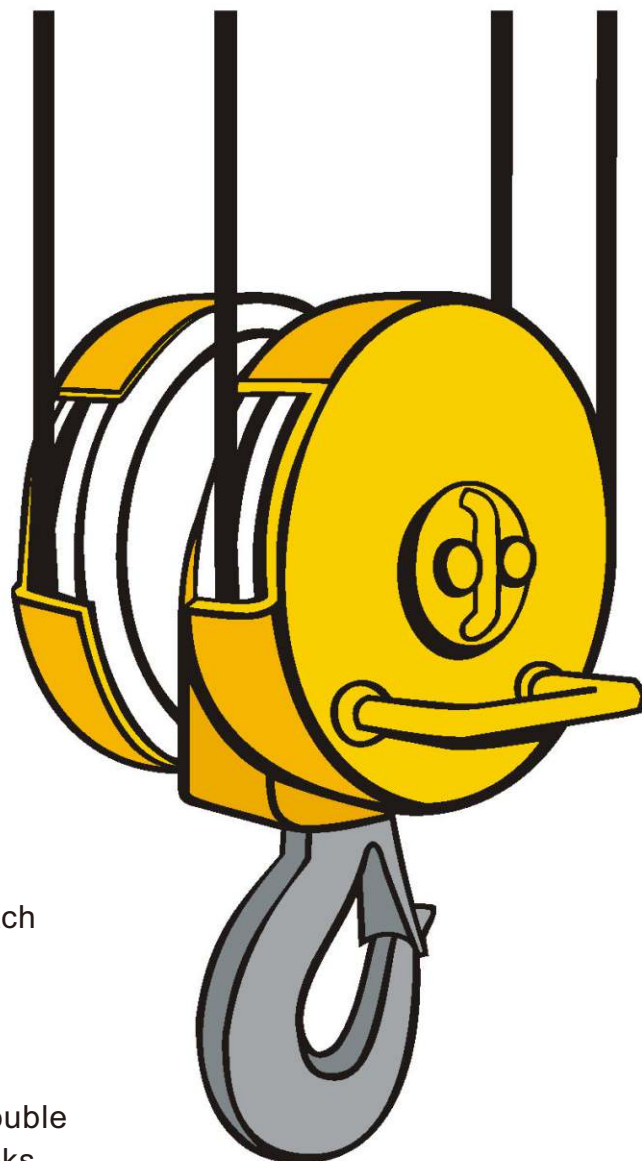

## Which hook to choose?

### Single hook for crane

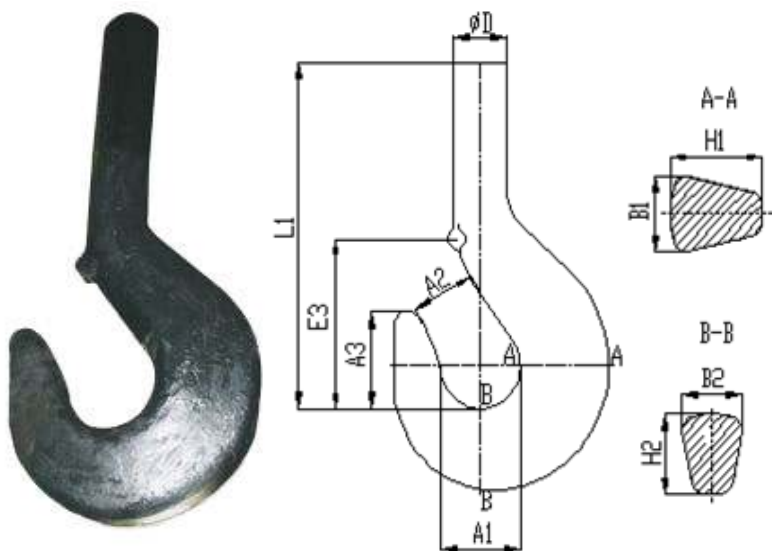

Capacity of Single Hook:  
5t/6t/10t/12t/16t/20t/25t/32t/40t/50t/63t/80t/100t/125t/160t/200t/250t

Single hook is easy to produce and use, but its load carrying is not good, so most of time, it is only used at the low capacity working site (less than 80T).

Hook No.	A1	A2	A3	φ h	E3	L1	B1	B2	H1	H2	Weight ( kg )
5#	80	63	90	53	165	318	71	60	90	75	13
6#	90	71	101	60	185	380	80	67	100	85	18
10#	112	90	127	75	221	460	100	85	125	106	40
12#	125	100	143	85	252	510	112	95	140	118	48
16#	140	112	160	95	280	595	125	106	160	132	80
20#	160	125	180	106	330	665	140	118	180	150	115
25#	180	140	202	118	360	724	160	132	200	170	140
32#	200	160	225	132	400	810	180	150	224	190	220
40#	224	180	252	150	447	905	200	170	250	212	310
50#	250	200	285	170	485	990	224	190	280	236	430
63#	280	224	320	190	550	1120	250	212	315	265	600
80#	315	250	358	212	598	1270	280	236	355	300	860
100#	355	280	402	236	688	1415	315	265	400	335	1220
125#	400	315	450	265	750	1590	355	300	450	375	1740
160#	450	355	505	300	825	1790	400	335	500	425	2480
200#	500	400	565	335	900	2048	450	375	560	475	3420
250#	560	450	635	375	980	2305	500	425	630	530	4800

## Double hook for crane

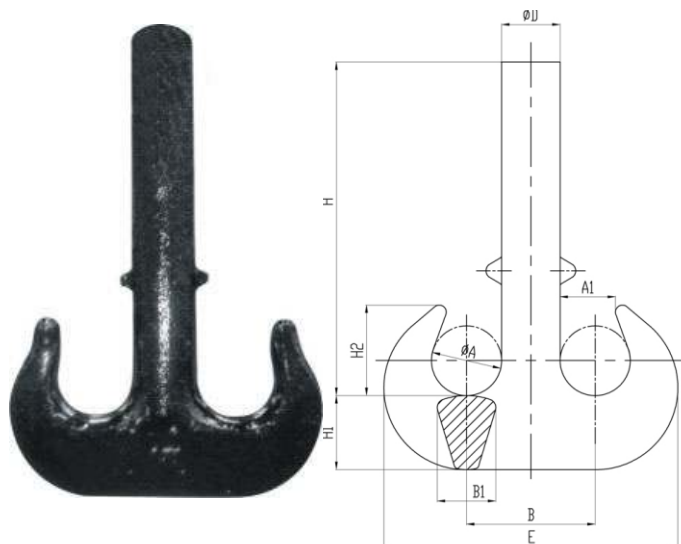

When the capacity is large, double hook with symmetrical load carrying will be used.

Capacity of double hook:  
10t/12t/16t/20t/25t/32t/40t/50t/63t/80t/100t/125t/160t/200t/250t.

Hook No.	φ D	φ A	A1	H	H1	H2	B1	B	E	Weight ( kg )
10#	75	90	71	505	95	116	75	165	377	36.3
12#	85	100	80	594	106	130	85	185	421	50.5
16#	95	112	90	642	118	146	95	207	471	71.1
20#	106	125	100	698	132	163	106	231	531	99.5
25#	118	140	112	750	150	182	118	258	598	138
32#	132	160	125	830	170	205	132	292	672	197
40#	150	180	140	930	190	230	150	330	754	286
50#	170	200	160	998	212	260	170	370	842	394
63#	190	224	180	1120	236	292	190	414	944	547
80#	212	250	200	1250	265	325	212	462	1062	759
100#	238	280	224	1400	300	364	238	518	1186	1060
125#	265	315	250	1600	335	408	265	580	1330	1491
160#	300	355	280	1800	375	458	300	655	1505	2115
200#	335	400	315	2000	425	515	335	735	1685	3015
250#	375	450	355	2250	475	580	375	825	1885	4268

## Strapped hooks



Strapped hooks is riveting by several cutting forming steel plate, respective steel plate has its safety feature is better, But its self-weight is large, mostly be used in large capacity or lifted molten steel cranes.

### General Drawing or Sketch or Draft Drawing

crane hook parameter																
Specification	Size(mm)												Steel wire rope		Weight(kg)	
	A	B	H	E	G	L	L1	L2	C	U	ΦD1	ΦD	Dia (mm)	Branch (pc)		
3.2T	637	338	380	245	130	222	/	/	50	65	/	250	11~14	4	80	
5T	846	382	480	320	236	/	184	/	65	85	/	350	11~14	4	100	
10T	1110	370	460	420	240	/	93	/	90	120	400	250	11~14	6	200	
16T	1277	512	660	440	285	/	179	/	115	150	500	300	14~20	6	330	
20T	1440	516	660	520	335	134	94	/	130	170	/	500	16~20	8	460	
32T	1730	596	780	610	420	154	108	/	160	210	/	610	18~22	8	845	
50T	2085	724	880	720	510	161	108	/	205	270	710	610	20~22	10	1500	
75T	2335	970	1012	930	600	185	135	/	250	320	800	500	26~32	10	1500	
100T	3130	1360	1162	1100	955	350	131	200	270	355	1000	800	28~34	12	4200	
200T	3548	1617	1090	1185	1298	159	264	/	/	340	1100	900	30~38	12	9100	

## Schematic diagram of hook unit structure

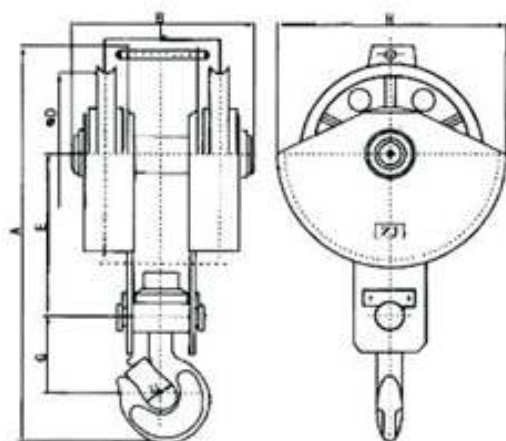

3.2T吊钩组  
(3.2T Hook unit)

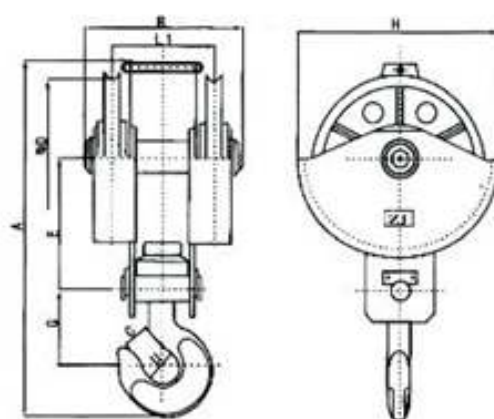

5T吊钩组  
(5T Hook unit)

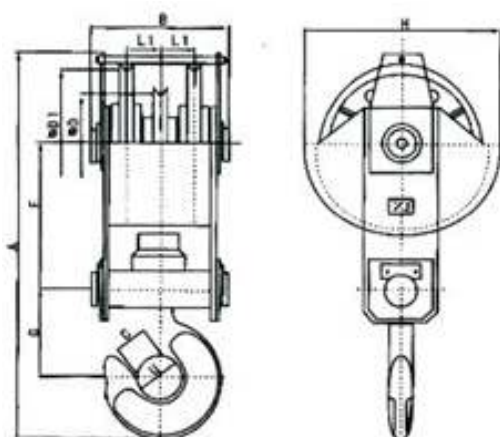

10T吊钩组  
(10T Hook unit)

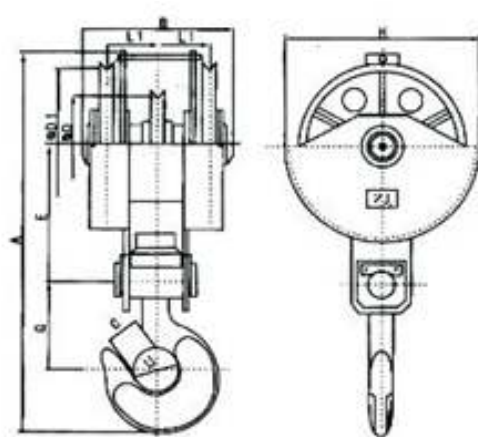

16T吊钩组  
(16T Hook unit)



# CRANE HOOK CATALOG

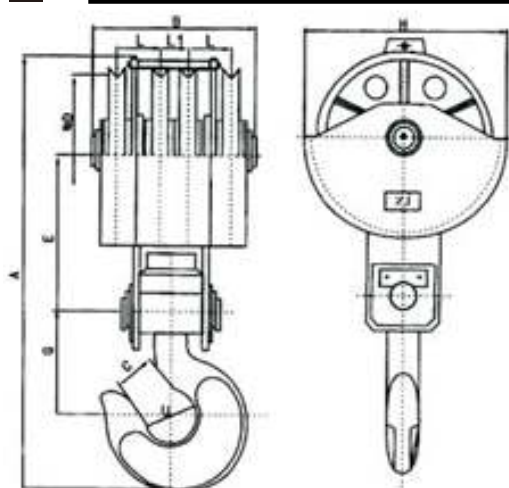

20T吊钩组  
(20T Hook unit)

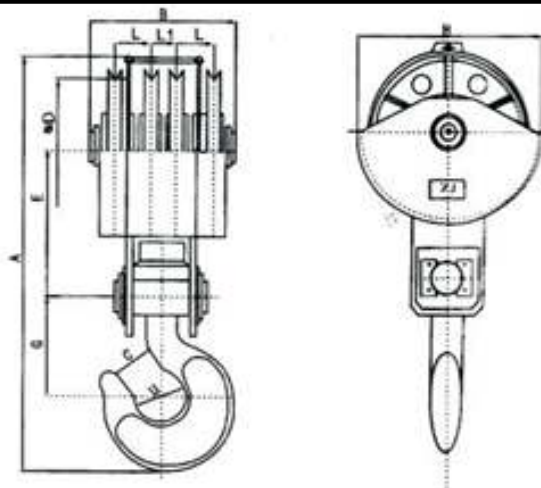

32T吊钩组  
(32T Hook unit)

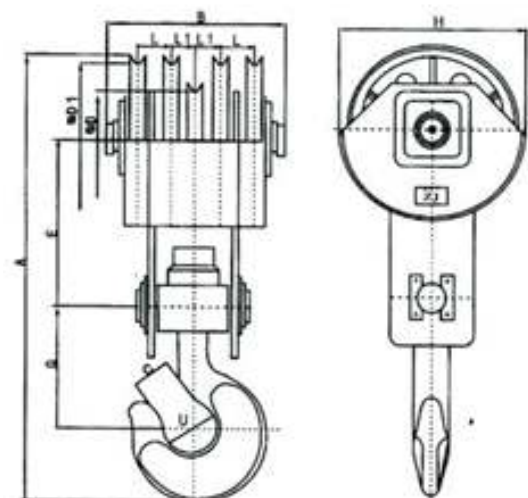

50T吊钩组  
(50T Hook unit)

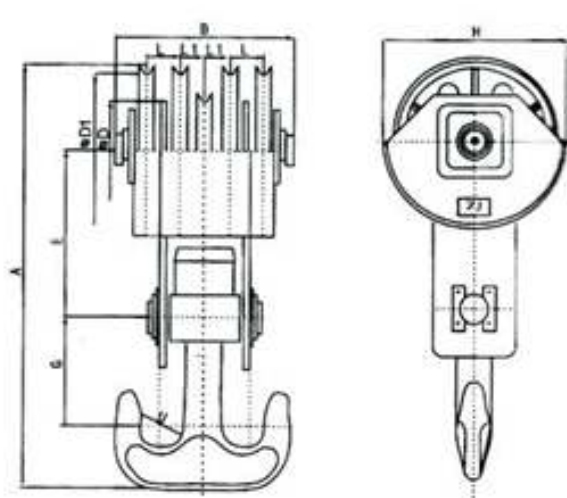

75T吊钩组  
(75T Hook unit)

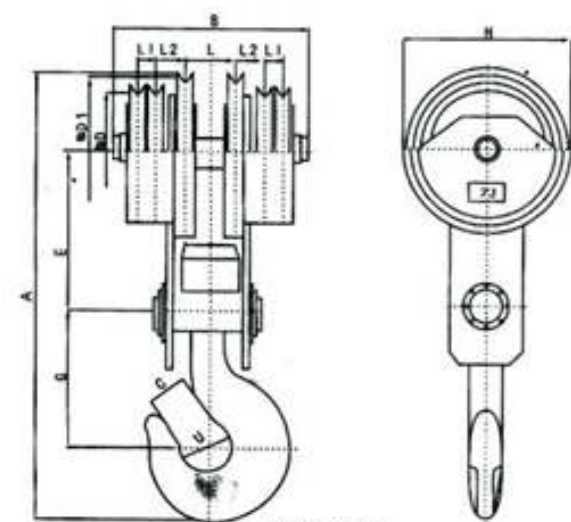

100T吊钩组  
(100T Hook unit)

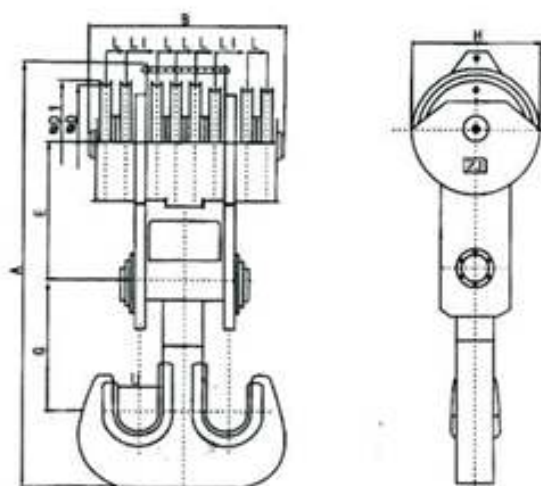

200T吊钩组  
(200T Hook unit)

## Manufacturing workshop and equipments of hooks

Five strength grades M, P, S, T, V, are classified in accordance with mechanical property. Forging hook and strap type hook are manufactured according to method of manufacturing.



### Hook Materials:

**M** grade with DG20, or DG20Mn

**P** grade with DG20Mn

**S** grade with DG34CrMo

**T** grade below 40t with DG34CrMo, more than 40t with DG34CrNiMo or DG30Cr2Ni2Mo

**V** grade below 40t with DG34CrNiMo or DG30Cr2Ni2Mo, more than 40t with DG30Cr2Ni2Mo.



## Different Strength Grade & Mechanism Working Grade & Hook Lifting Capacity

Strength Grade	Mechanism Working Grade (According to Gb3811)										Strength Grade
M	-	-	-	-	M3	M4	M5	M6	M7	M8	M
P	-	-	-	M3	M4	M5	M6	M7	M8	-	P
(S)	-	-	M3	M4	M5	M6	M7	M8	-	-	(S)
T	-	M3	M4	M5	M6	M7	M8	-	-	-	T
(V)	M3	M4	M5	M6	M7	M8	-	-	-	-	(V)
Hook No.	Lifting Capacity (t)										Hook No.
5	25	20	16	12.5	10	8	6.3	5	4	3.2	5
6	32	25	20	16	12.5	10	8	6.3	5	4	6
10	50	40	32	25	20	16	12.5	10	8	6.3	10
12	63	50	40	32	25	20	16	12.5	10	8	12
16	80	63	50	40	32	25	20	16	12.5	10	16
20	100	80	63	50	40	32	25	20	16	12.5	20
25	125	100	80	63	50	40	32	25	20	16	25
32	160	125	100	80	63	50	40	32	25	20	32
40	200	160	125	100	80	63	50	40	32	25	40
50	250	200	160	125	100	80	63	50	40	32	50
63	320	250	200	160	125	100	80	63	50	40	63
80	400	320	250	200	160	125	100	80	63	50	80
100	500	400	320	250	200	160	125	100	80	63	100
125	-	500	400	320	250	200	160	125	100	80	125
150	-	-	500	400	320	250	200	160	125	100	150
200	-	-	-	500	400	320	250	200	160	125	200
250	-	-	-	-	500	400	320	250	200	160	250

Note: If working grade below M3, pls take it as M3 into consideration.

Hook No.	Shank Diameter Φ D (mm)	Strength Grade				
		M	P	(S)	T	(V)
5	53	DG20 Or DG20Mn	DG20Mn	DG34CrMo	DG34CrMo	DG34CrNiMo Or DG30Cr2Ni2Mo
6	60					
10	75					
12	85					
16	95					
20	106					
25	118					
32	132					
40	150					
50	170				DG34CrNiMo Or DG30Cr2Ni2Mo	DG30Cr2Ni2Mo
63	190					
80	212					
100	236					
125	265					
160	300					
200	335					
250	375					

## Processing machine



5t linkage manipulator



5t manipulator for material handling



60t manipulator



annealing furnace



C61200 horizontal lathe



CNC



YJM4232 gantry machining center



Table saw



TQ32-6000 Hydraulic Press



10000t Hydraulic Press



2000t tensile testing machine



## Hook block



**Single hook**



**Double hook**



**Laminated hook**



**Single hook**



**Electric rotary hook**



**Ex-proof hook**



## Our hook warehouse



## Hook Test

In order to ensure safety, hook must pass the test, when found to be one of the following conditions, the hook must be set to be scrapped, welding repair is not allowed.

### Rack appeared.

The dangerous section of wear is made according to GB10051.2 hook, no more than 5% of the original height; According to standard line continue to use the hook, should be more than 10% of the original size.

Openness is increased by 15% of the originals.

Reverse deformation more than 10 degrees.

Dangerous section or a hook neck produces plastic deformation.

Late hook liner wear is up to 50% of the original size, the core set of should be scrap.

Board hook core shaft wear is up to 5% of the original size, the spindle should be scrap.



Impact testing machine



Universal testing machine



MT inspection



UT inspection



## Package and delivery of hooks



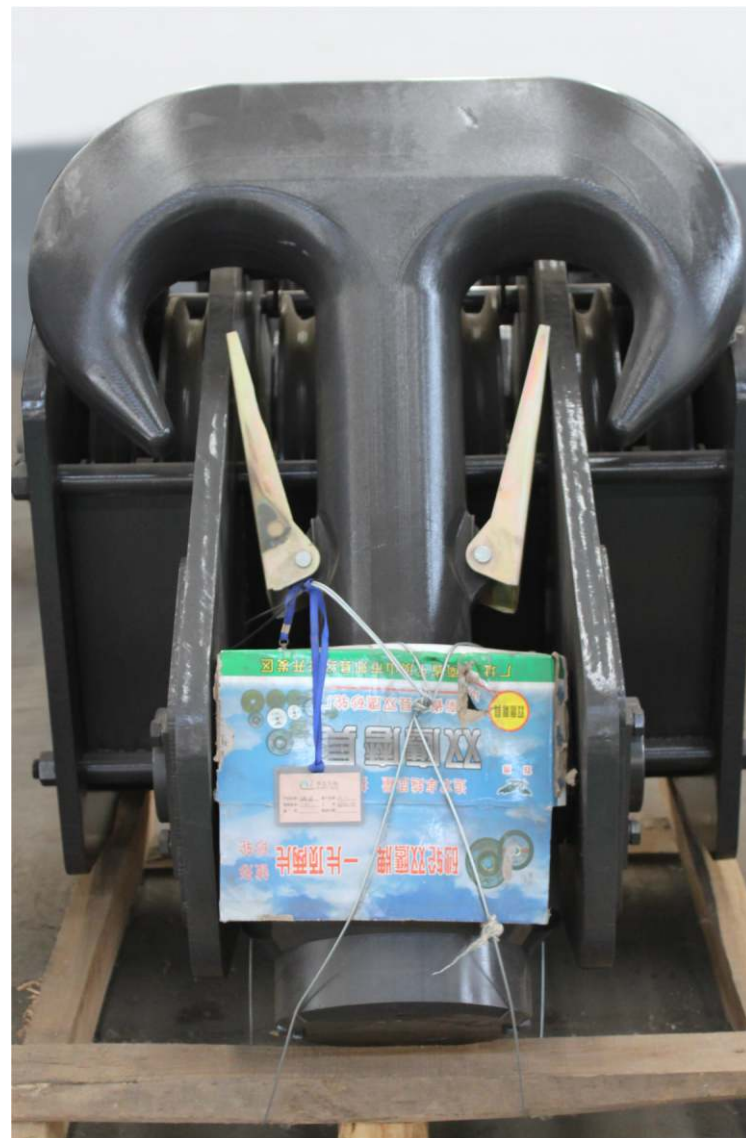



keeping industry on the move

Email: [info@dgcrane.com](mailto:info@dgcrane.com) Tel: +86-373-3876188

Fax: +86-373-3876088 M.p: +86-18638327972 Web: [www.dgcrane.com](http://www.dgcrane.com)

ADD: Changnao Industrial District,Xinxiang city,Henan province,China